



4 The Mainbrace Tweed Heads NSW

5 🛏 4 🚿 2 🚗

Perched in a premier Tweed Heads position, this exemplary single-level home supplies the perfect fusion of luxury living and relaxing family retreat. Offering sweeping water views, a private sandy stretch of waterfront access and superlative outdoor entertaining, will leave you feeling you've claimed a prized sanctuary of your very own.

Showcasing a coastal aesthetic and design that presents those water views at every opportunity, an airy layout includes a large rumpus room and open-plan living and dining. The modern kitchen boasts wall-to-wall cabinetry, a butler's pantry, new induction cooking and sleek stone. Large covered patio captures a southerly aspect and a wide water vista with a built-in BBQ kitchen for first-class

Type : House
Price : \$2,599,000
Building Size : 829 sqm
Land Size : 829 sqm
View : <https://www.byronbaypropertyvalues.com.au/sale/nsw/northern-rivers/tweed-heads/residential/house/8116679>



Jessica Wallace

[For full version visit the website](https://www.byronbaypropertyvalues.com.au)



FLOOR PLAN

The site plan and floor plan are not to scale; measurements are indicative and in meters. Brushes and trees are placed for illustration purposes. Plan should not be relied on. Interested parties should make and rely on their own enquiries.

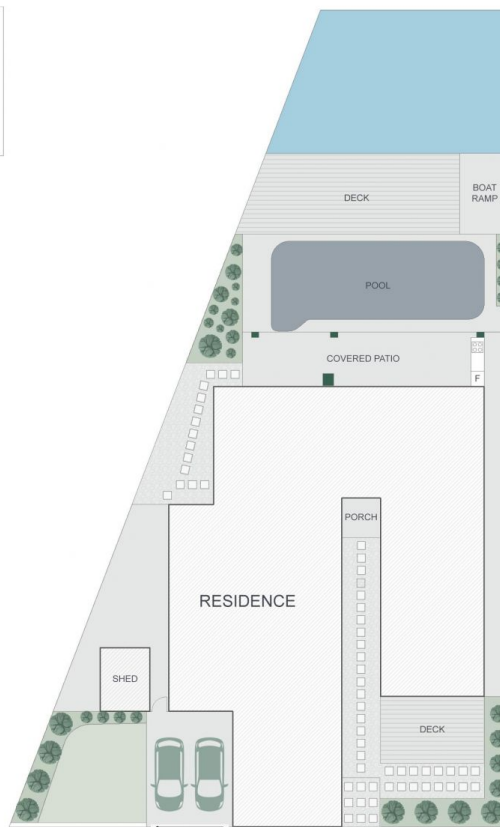

SITE PLAN



APPROXIMATE AREAS	
Internal Area	293 sqm
External Area	36 sqm
Total Area	329 sqm
Land Size	829 sqm