



40 Hillcrest Avenue Tweed Heads South NSW

3 3 2

Merging an updated interior with stunning views, this home delivers coastal perfection in a location that has it all. Boasting a versatile layout with the options for dual living, you'll marvel at the magnificent outlook of the Tweed estuary whilst everyday amenities are all close by.

A coastal palette with Hampton's elements and timber-styled flooring brings broad appeal to open-plan living and dining, with high-raked ceilings amplifying the space throughout. Sleek and modern, the spacious kitchen blends style and function with good storage, quality appliances and waterfall stone.

Outside, a vast covered deck has stunning hinterland

[For full version visit the website](https://www.byronbaypropertyvalues.com.au)

Type : House
Price : \$ 1,190,000
Building Size : 334 sqm
Land Size : 613 sqm
View : <https://www.byronbaypropertyvalues.com.au/sale/nsw/northern-rivers/tweed-heads-south/residential/house/8121803>



Jessica Wallace



Braden Walters

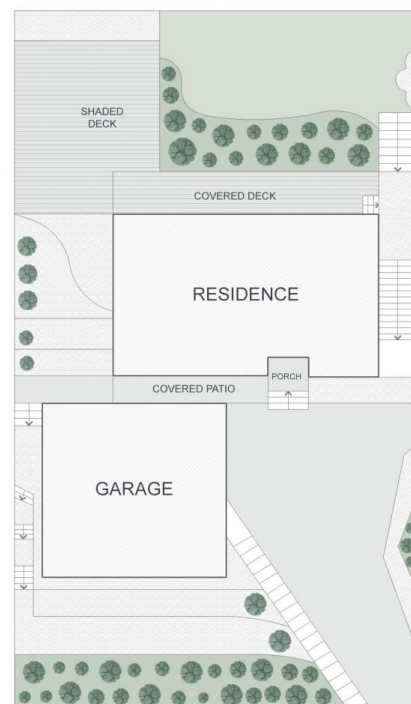

The site plan and floor plan are not to scale; measurements are indicative and in meters.
Brushes and trees are placed for illustration purposes. Plan should not be relied on.
Interested parties should make and rely on their own enquiries.



| APPROXIMATE AREAS | |
|-------------------|---------|
| Internal Area | 225 sqm |
| External Area | 109 sqm |
| Total Area | 334 sqm |
| Land Size | 613 sqm |